



1 LOCALITY PLAN
NTS

LANDSCAPE DESIGN STATEMENT

The New Hope campus to be located within the grounds of the Pacific Hills Christian School (PHCS) and is a purpose-built education facility catering for students from K 12 who have mild intellectual disabilities or Autism Spectrum Disorder (ASD).

The design of the new campus has been undertaken in a collaborative manner with the teams Architects and Engineers and has undergone a process of stakeholder engagement with staff from Hew Hope and PHCS.

The landscape design has been integrated with the built elements and when complete the landscape spaces will appear as cohesive and well-connected areas.

- The overarching design principles are:
- ? To create a positive image within the community to engender pride in the school and its surrounds;
 - ? To create a non-threatening and secure environment for the students;
 - ? To provide environmental comfort to all users;
 - ? To create a connection to the wider school campus;

The landscape spaces will offer opportunity for the students to play, learn and socialise in a safe and secure environment. The building and landscape spaces offer sufficient capacity and flexibility such that special events involving students, parents and invited guests can occur in comfort, for example year end assemblies, concerts and social occasions.

The site is well connected to existing school facilities with pedestrian access to the oval to the north and the main campus to the east.

- The landscape design incorporates:
- ? Retained boundary hedge planting to the south and west enhanced with new canopy tree planting, shrubs, grasses and groundcovers garden
 - ? garden areas with tree, shrub and groundcover planting to the new carpark, traffic islands, and arrival spaces;
 - ? appropriate landscape treatments to school open space areas with provision for
 - (a) open play spaces;
 - (b) fixed play equipment areas; and
 - (c) outdoor learning spaces directly connected to classrooms.

- The design accommodates the following principles to assist children with intellectual disability and ASD to engage in play and outdoor learning activities:
- ? Provide for physical play that is age appropriate and provides a progression of challenge;
 - ? Provide for imaginative play;
 - ? Have structured movement with clearly defined paths, preferably circuits and not linear;
 - ? Provide for interaction;
 - ? Provide for retreat and observation by individuals;
 - ? Pleasant environmental conditions;
 - ? Interaction with nature.

- The landscape design accommodates the following play elements to achieve the principles of play outlined above:
- ? Fixed play equipment and open areas for movement and activity to allow for development of gross motor skills;
 - ? Herb and Vegetable gardens planting for group use and "paddock to plate" learning;
 - ? Sensory garden with a range of plant types and ground textures with Asthma and Allergy friendly plant species;
 - ? Elevated observation areas to allow outlook over play space;
 - ? Shade in the form of structures and trees;
 - ? Coloured pavements with low glare / non reflective qualities;
 - ? Well defined outdoor spaces enclosed by planting;
 - ? Clearly defined paths and ramps for wayfinding with clearly define edges to assist sight impaired students.
 - ? Secure boundary fencing that is non climbable

Materials selection (hard and soft landscape elements) have been made on the basis that they are robust, fit for purpose and suitable for use within a school environment.

Equitable access provides opportunity for access to key site play and learning areas.

- The main landscape features of the site are:
- North facing sloping land with a cross fall of approximately 9.0 metres
 - No significant vegetation
 - Fenced boundary areas with hedge planting;
 - Adjoining land uses: residential to the south and plant nursery to the west with school property to the north and east
 - Outlook to adjoining open space areas, sports fields and bushland.

The site is accessed by an unformed lane to the east connecting with Quarry Road. There are no natural features on the site such as rock outcrops and the like. The site is not in a heritage conservation zone. The north western corner of the site is in a bushfire zone.

Landscape Strategies
Planting using semi advance and advanced container sizes will occur to ensure an immediate impact is achieved. Advanced tree sizes of 75 to 100 Litre will occur to ensure their establishment in high use areas. Tree planting will be provided to shade play spaces and create interest through seasonal displays of flowers and foliage.

Plant species will be selected for their low allergenic qualities, yet provide interest through a variety of floral displays and foliage habits. Sensory planting, bush tucker planting and herb / vegetable gardens are to be proposed.

A range of fencing types and styles are proposed in order to define various play spaces. Planting is encouraged to grow through fences to softening their appearance. Plant species have been selected using the Hills Shire Council recommended plant species list refer DCP 2012 Section C3, in conjunction with species that are known to thrive on the existing campus.

Carparking
The proposed new carpark is extensively landscaped with a 2.0 metre wide centre landscape strip containing shade trees, shrubs and groundcovers. The southern boundary features a 4.0 metre wide landscape strip contain shade trees and retaining and existing boundary hedge. Boundary hedge planting is to be retained on the western boundary. Two traffic islands near the main building entry are to be extensively planted with shade trees, shrubs, grasses and groundcovers.

The landscape areas are protected by raised kerbs and wheel stops.

Boundary Fencing
The existing 1.8 m high metal palisade boundary fencing to the lane way from Quarry Road, to the southern and western residential boundaries is to be retained.

New fencing will work in conjunction with building lines to secure the New Hope Campus. This will be a 2.4 metre metal palisade fence and where possible planting is to occur to soften fence lines and provide enhanced privacy and acoustic separation.

Balustrades are proposed above the northern slab edges to 1.6 metre high using metal and glass to meet BCA standards.

Streetscape
The existing access lane at the main school entry off Quarry Road will be utilised for vehicle access to the New Hope campus.

Irrigation and Maintenance
All garden areas are readily accessible for ease of maintenance. Plant species have been selected for their hardiness and ability to withstand the site conditions. All garden areas are to be mulched to aid plant establishment and weed suppression. All garden and turf areas are to be appropriately edged for ease of maintenance, refer details.

Planting in carparks is to be pruned in order to maintain clear sightlines to signage, intersections and pedestrian crossings.

The installation of the works will be undertaken by a qualified landscape contractor and will be subject to a minimum twelve month defects liability period. During this time the contractor will be required to undertake regular maintenance visits, replace failed plants and rectify defects. After this period the ongoing maintenance will be the responsibility of the school.

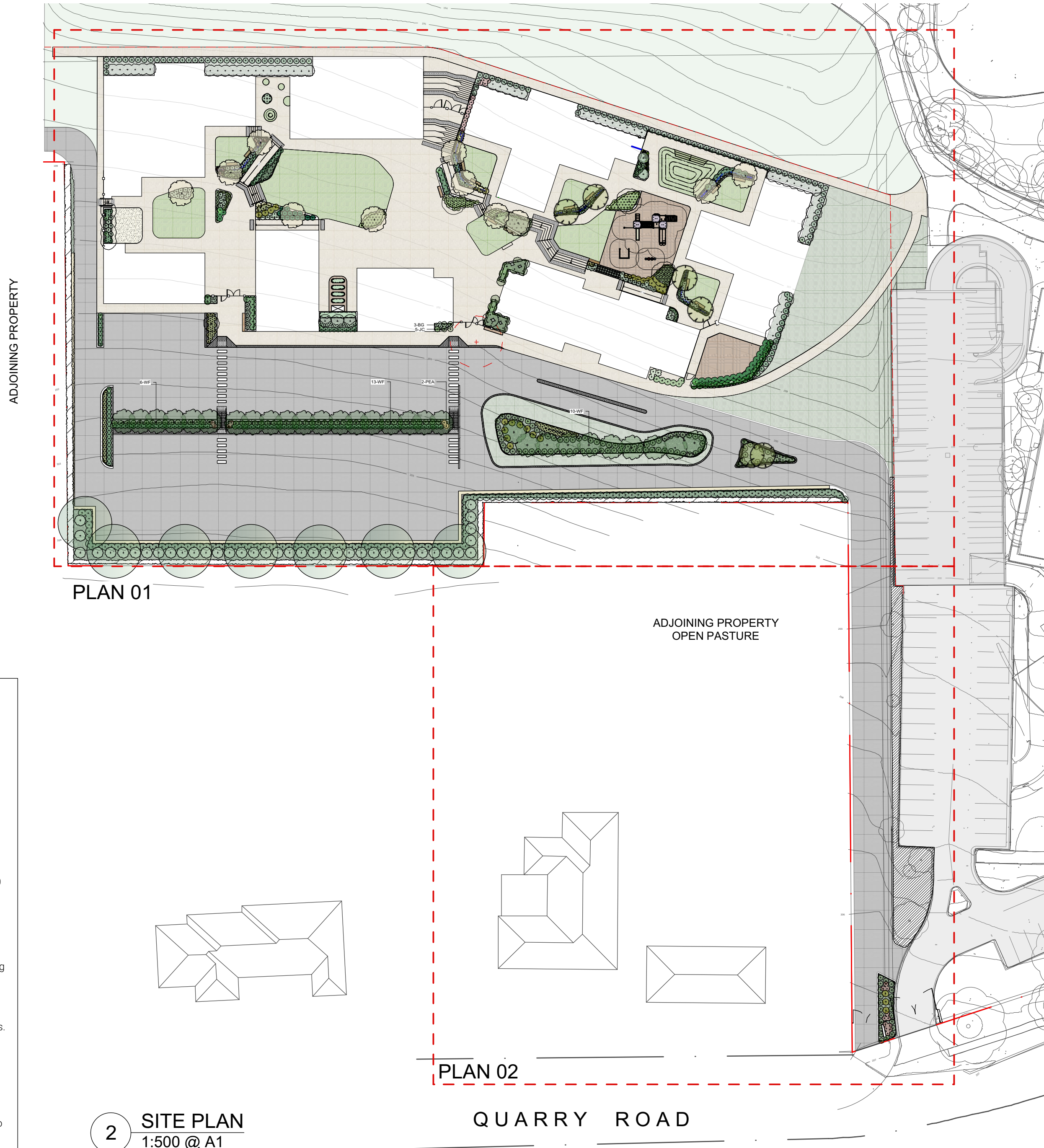

2 SITE PLAN
1:500 @ A1

LANDSCAPE DEVELOPMENT APPLICATION - DRAWING SCHEDULE			
SHEET No.	TITLE	SCALE	REVISION NO.
LDA000	COVER PAGE	As Shown @ A1	B
LDA100	LANDSCAPE ARRANGEMENT PLAN 01	1:200@ A1 1:400@ A3	B
LDA101	LANDSCAPE ARRANGEMENT PLAN 02	1:200@ A1 1:400@ A3	B
LDA200	LANDSCAPE SECTIONS	As Shown @ A1	B
LDA300	PLANTING PALETTE	N/A	B
LDA400	LANDSCAPE DETAILS/ SPEC	N/A	B

Issue No.	Date	Description	Chkd
A	17/07/2019	Preliminary Issue for Coordination	KC
B	28/08/2019	Issue for DA	KC

DEVELOPMENT APPLICATION

NEW HOPE CAMPUS | PACIFIC HILLS CHRISTIAN SCHOOL

9 QUARRY ROAD, DURAL NSW 2158

Drawing Title
COVER PAGE

Project
NEW HOPE CAMPUS

Location
9 QUARRY ROAD, DURAL NSW 2158

Client
PACIFIC HILLS CHRISTIAN SCHOOL

Landscape Architect
NBRSLARCHITECTURELANDSCAPE

Level 3, 4 Glen Street, Milsoms Point. NSW 2061 Australia
T: 61 2 9922 2344 F: 61 2 9922 1308
E: architects@nbrsarchitecture.com W: nbrsarchitecture.com

Any form of replication of this drawing in full or in part without the written permission of NBRSL & PARTNERS Pty Ltd constitutes an infringement of the copyright
ABN 16 002 247 565 © 2019

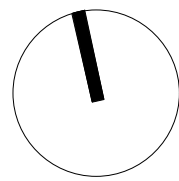

Date 28/08/2019
Scale As Shown @ A1
20 M

Project No. 17369
Sheet No. LDA000
Revision No. B

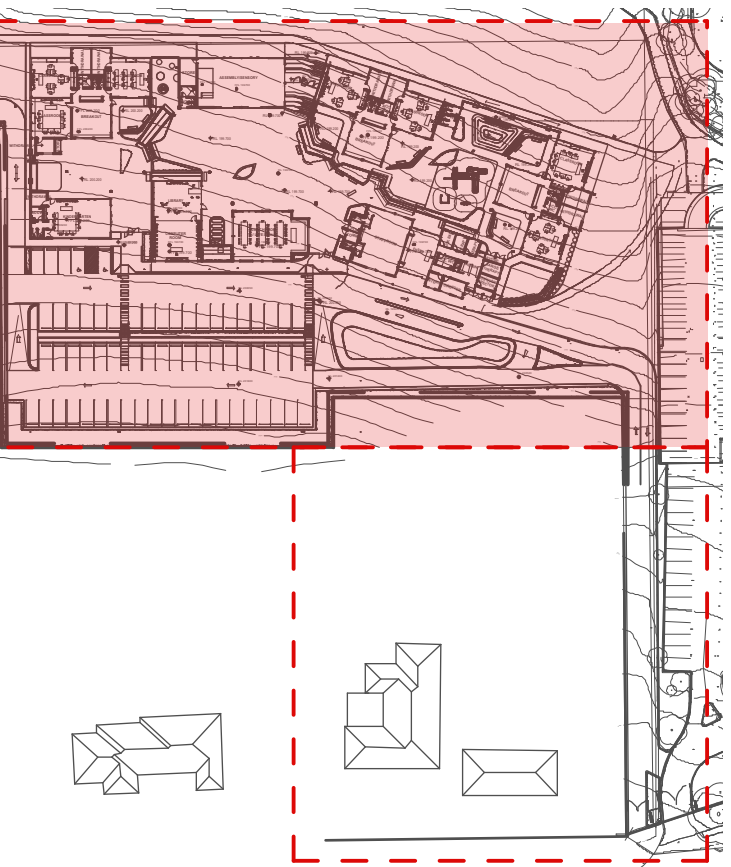
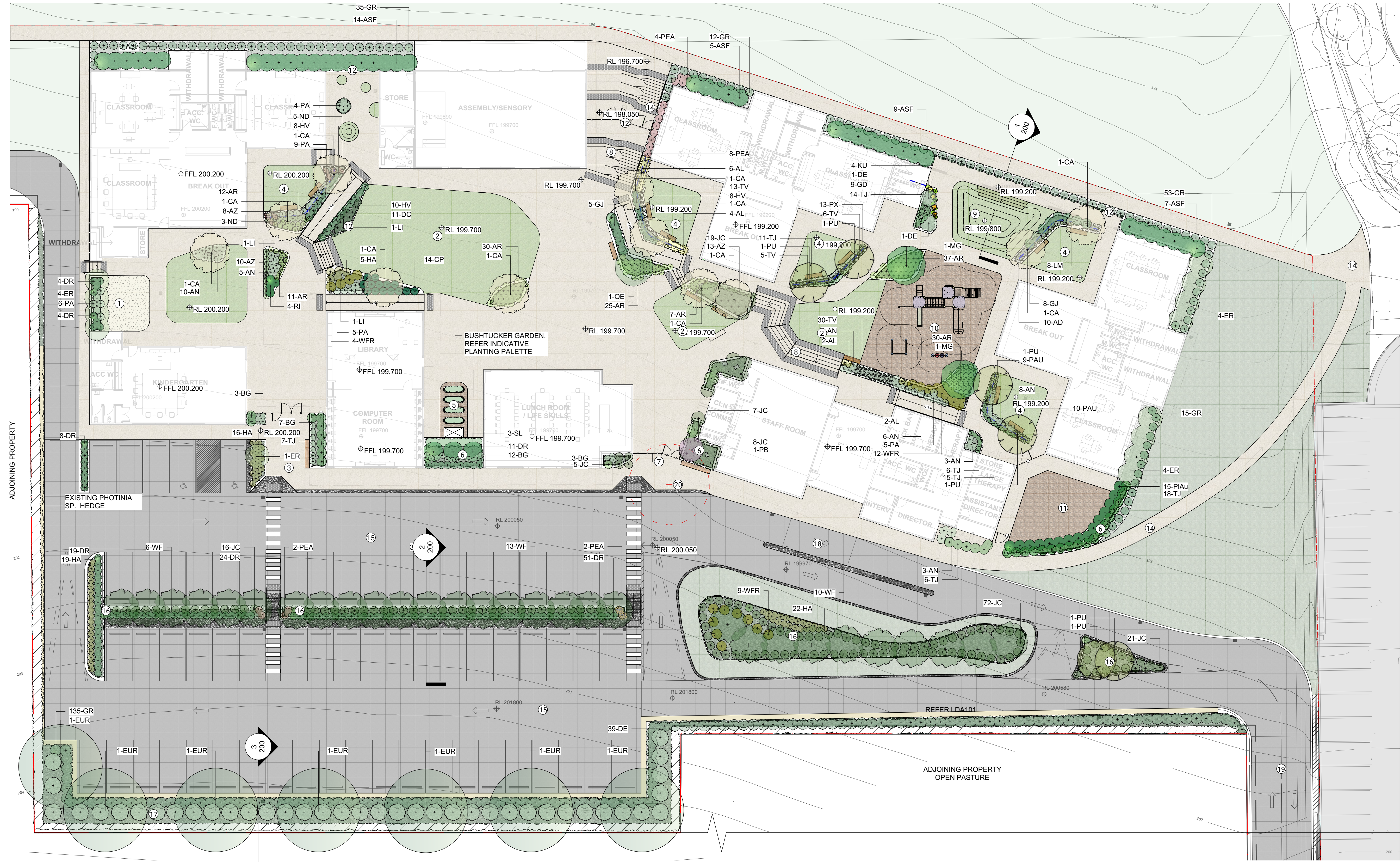

- 1 SAND AND WATER PLAY SPACE
- 2 SYNTHETIC TURF
- 3 GARDENS AND SEATING AT ENTRY TO ENCOURAGE GATHERING
- 4 EXTERNAL CLASSROOM BREAKOUT SPACE FEATURING LOW HEIGHT SCREEN FENCE, ORNAMENTAL TREES, SHRUBS AND GRASSES WITH LAWN.
- 5 RAISED VEGETABLE GARDEN FOR HERB / VEGETABLE / BUSH TUCKER PLANTING, WORM FARM, AND COMPOST BIN.
- 6 GARDEN AREA BETWEEN BUILDING WITH PLANTING TO SOFTEN THE FENCE LINE.
- 7 MAIN ENTRY MOMENT TO SCHOOL
- 8 STEPPED SEATING AREA
- 9 SYNTHETIC TURF MOUND
- 10 RELOCATED FIXED PLAY EQUIPMENT ON RUBBER SOFTFALL
- 11 FENCED PLAY SPACE WITH EQUIPMENT THAT REQUIRES HIGHER SUPERVISION
- 12 CLIMB PROOF BOUNDARY SECURITY FENCE
- 13 SHADE TREE PLANTING
- 14 CONNECTION TO EXISTING SCHOOL
- 15 NEW HOPE CAMPUS CARPARK
- 16 EXTENSIVE PLANTING TO ISLAND GARDEN BEDS
- 17 RETAIN EXISTING HEDGE AND INTRODUCE TALL NATIVE TREE PLANTING TO SOFTEN BOUNDARY
- 18 DROP OFF BAY
- 19 NEW HOPE CAMPUS ENTRY DRIVEWAY
- 20 EXISTING TREE TO BE REMOVED

1 LANDSCAPE PLAN 01
1:200 @A1

Issue No.	Date	Description	Chkd
A	17/07/2019	Preliminary Issue for Coordination	KC
B	28/08/2019	Issue for DA	KC

LEGEND

- SITE BOUNDARY
- PROPOSED GROUND LEVEL
- EXISTING GROUND LEVEL
- LOW HEIGHT SCREEN FENCE

- 2.4m PALLISADE FENCE
- STORE LOCATION
- SEATING

- COLOURED CONCRETE
- PLAYGROUND MULCH
- PLAYGROUND SOFTFALL

- NATURAL TURF
- SYNTHETIC TURF
- SAND

- DECIDUOUS TREE
- EVERGREEN TREE
- SHRUBS, GROUND COVERS & GRASSES

Drawing Title
LANDSCAPE ARRANGEMENT PLAN 01

Project
NEW HOPE CAMPUS
Location
9 QUARRY ROAD, DURAL NSW 2158
Client
PACIFIC HILLS CHRISTIAN SCHOOL

Landscape Architect
NBRSLANDSCAPE
Level 3, 4 Glen Street, Milsons Point, NSW 2061 Australia
T: 61 2 9922 2344 F: 61 2 9922 1308
E: architects@nbrsarchitecture.com W: nbrsarchitecture.com
Any form of replication of this drawing in full or in part without the written permission of NBRSLANDSCAPE Pty Ltd constitutes an infringement of the copyright.
AS/NZS 16:002:247:965 © 2019

Date 28/08/2019
Scale 1:200 @ A1 | 1:400 @ A3

Project No. 17369
Sheet No. LDA100
Revision No. B



PLANTING SCHEDULE

Plant List					
ID	Qty	Botanical Name	Common Name	Scheduled Size	Remarks
Trees					
CA	11	<i>Cupaniopsis anacardioides</i>	Tuckeroo	45LT	
ER	13	<i>Elaeocarpus reticulatus</i>	Blueberry Ash	75LT	
EUR	7	<i>Eucalyptus robusta</i>	Swamp Mahogany	100LT	
LI	3	<i>Lagerstroemia indica 'Natchez'</i>	Crepe Myrtle	200LT	
MG	2	<i>Magnolia grandiflora 'Little Gem'</i>	Little Gem Southern Magnolia	75LT	
PB	1	<i>Prunus x blireana</i>	Blireana Plum	200LT	
PU	6	<i>Pyrus ussuriensis</i>	Manchurian pear	100LT	
QE	1	<i>Quercus ilex</i>	Evergreen Oak	400LT	
SL	3	<i>Syzygium luehmannii</i>	Small-leaf Lilly Pilly	45LT	
WF	29	<i>Waterhousia floribunda</i>	Weeping Lilly Pilly	100LT	
Shrubs					
ASF	41	<i>Acmena smithii</i>	Lillypilly	45LT	
AL	14	<i>Alpinia zerumbet 'Variegata'</i>	Variegated Shell Ginger	15LT	
AD	18	<i>Alternanthera dentata</i>	Little Ruby	5LT	
AZ	31	<i>Anigozanthos 'Bush Blaze'</i>	Bush Blaze Kangaroo Paws	5LT	
AN	38	<i>Asplenium nidus</i>	Birds-Nest Fern	5LT	
CP	14	<i>Carex appressa</i>	Tall Sedge	2.5LT	
DC	11	<i>Dianella caerulea</i>	Blue Flax-lily	2.5LT	
DR	121	<i>Dianella revoluta</i>	Blue Flax Lily	2.5LT	
DE	41	<i>Doryanthes excelsa</i>	Gymea Lily	15LT	
GJ	13	<i>Gardenia jasminoides</i>	Gardenia	25LT	
GR	265	<i>Grevillea 'Royal Mantle'</i>	Royal Mantle Grevillea	2.5LT	
HA	62	<i>Hebe albicans</i>	Hebe	5LT	
KU	4	<i>Kniphofia uvaria</i>	Red Hot Poker	5LT	
LM	8	<i>Liriope muscari</i>	Big Blue Lilly Turf	5LT	
ND	8	<i>Nandina domestica</i>	Sacred Bamboo	25LT	
PA	29	<i>Pennisetum alopecuroides</i>	Fountain Grass	5LT	
PEA	29	<i>Pennisetum setaceum 'Rubrum'</i>	Purple Fountain Grass	5LT	
PX	13	<i>Philodendron Xanadu</i>	Philodendron	5LT	
PAU	19	<i>Phlebodium aureum</i>	Blue Star Fern	5LT	
PIAu	30	<i>Plumbago auriculata</i>	Plumbago	25LT	
RI	4	<i>Rhaphiolepis indica</i>	Indian Hawthorn	15LT	
TV	54	<i>Tulbaghia violacea</i>	Society Garlic	2.5LT	
WFR	28	<i>Westringia fruticosa</i>	Coastal Rosemary	15LT	
Ground Covers					
AR	152	<i>Ajuga reptans</i>	Bugle, Wild Mint	5LT	
BG	25	<i>Blechnum gibbum 'Silver Lady'</i>	Silver Lady	5LT	
GD	9	<i>Gazania 'Double Gold'</i>	Double Gold Gazania	2.5LT	
HV	26	<i>Hardenbergia violacea</i>	Purple Twining-pea	5LT	
JC	203	<i>Juniperus conferta</i>	Shore Juniper	5LT	
TJ	97	<i>Trachelospermum jasminoides</i>	Star Jasmine	15LT	
Grasses					
Total	1483				

BUSH TUCKER SPECIES LIST

Sensory Garden		
Touch		
JC	<i>Juniperus conferta</i>	Shore Juniper #*
SA	<i>Salvia argentea</i>	Silver Sage
SB	<i>Stachys byzantia</i>	Lambs Ears
ZF	<i>Zamia furfuracea</i>	Cardboard Palm
Taste		
AS	<i>Allium schoenoprasum</i>	Chives
CP	<i>Carum petroselinum</i>	Parsley
MS	<i>Mentha spicata</i>	Mint
Smell		
LD	<i>Lavandula dentata</i>	Lavender
MV	<i>Mentha var</i>	Mint
PS	<i>Pelargonium sp.</i>	Scented Leaf Pelargonium
RO	<i>Rosemary officinalis</i>	Rosemary
Sight		
HA	<i>Helianthus annuus</i>	Sunflower
KP	<i>Kniphofia praecox</i>	Red Hot Poker
Sound		
AD	<i>Allocasuarina distyla</i>	Scrub She Oak
Bush Tucker Planting		
Tree Planting		
BC	<i>Backhousia citriodora</i>	Lemon Myrtle *#
DP	<i>Davidsonia pruriens</i>	Davidsons Plum
LA	<i>Livistona australis</i>	Cabbage Tree Palm #
Shrub Planting		
AL	<i>Acacia longifolia</i>	Sydney Golden Wattle *
ALC	<i>Alpinia caureulea</i>	Native Ginger
BE	<i>Banksia ericifolia</i>	Heath Banksia
CAL	<i>Callistemon species</i>	Bottle Brush *#
CS	<i>Cordylina stricta</i>	Slender Palm Lilly
CYA	<i>Cyathea australis</i>	Rough Tree Fern
EL	<i>Eupomatia laurina</i>	Bolwarra
GV	<i>Grevillea var</i>	Sandra Gordon
XA	<i>Xanthorrhoea australis</i>	Grass Tree
Groundcovers / Climbers		
BI	<i>Blechnum indicum</i>	Bunwall Fern
CAN	<i>Cissus antarctica</i>	Native Grapes
PAS	<i>Passiflora herbertiana</i>	Wild Passionfruit
PK	<i>Poa poiformis Kingsdale</i>	Blue Coastal Tussock Grass #
RH	<i>Rubus hillii</i>	Native Raspberry
Herb Garden		
AR	<i>Armoracia rusticana</i>	Horseradish
AS	<i>Allium schoenoprasum</i>	Chives
CC	<i>Cymbopogon citratus</i>	Lemon Grass
OV	<i>Origanum vulgare</i>	Oregano
RO	<i>Rosemary officinalis</i>	Rosemary
SO	<i>Salvia officinalis</i>	Sage
ZO	<i>Zingiber officinale</i>	Ginger
Citrus Orchard		
CIA	<i>Citrus aurantifolia</i>	Tahitian Lime
CIL	<i>Citrus x limon Eureka</i>	Eureka' Lemon
CIR	<i>Citrus reticulata</i>	Mandarin
CIS	<i>Citrus x sinensis</i>	Valencia' Orange

* PLANTING OF THESE SPECIES BY SCHOOL AS PART OF THE CURRICULUM

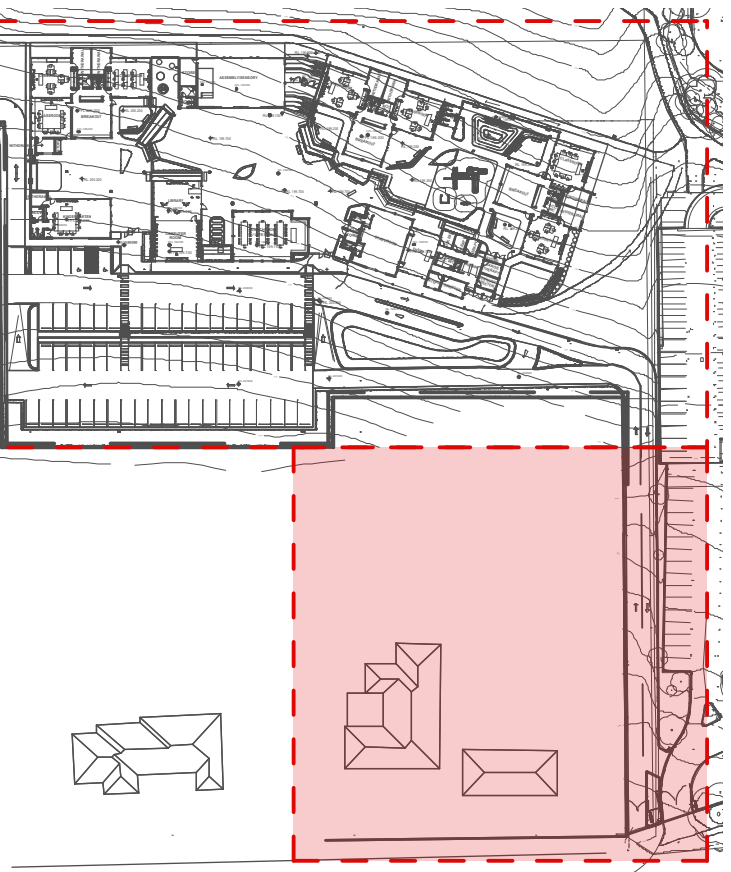
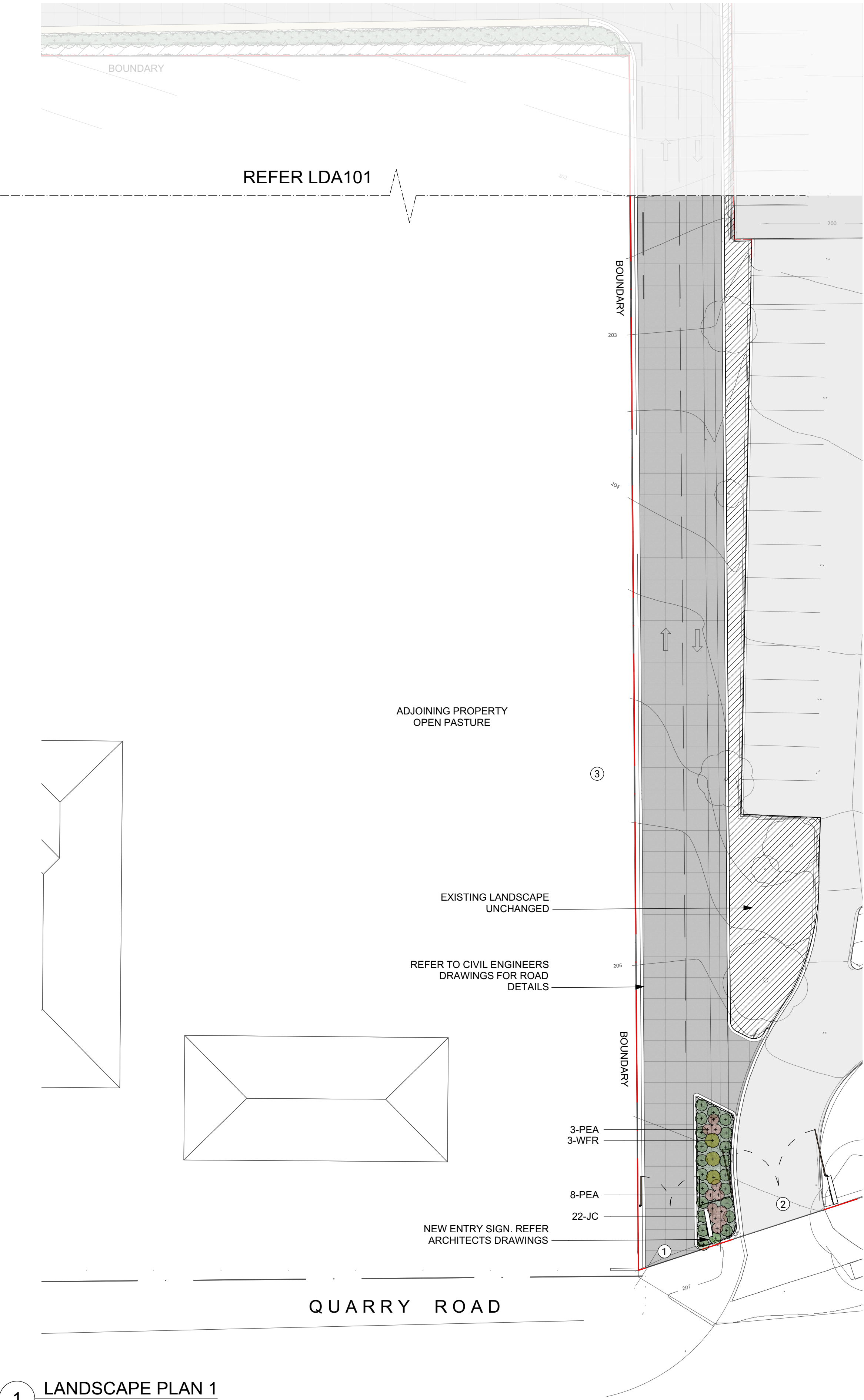

- 1 ENTRY FOR NEW HOPE CAMPUS
- 2 EXISTING ENTRY TO PHCS
- 3 RETAIN EXISTING HEDGE ALONG BOUNDARY TO SOFTEN BOUNDARY FENCE

1 LANDSCAPE PLAN 1
1:100 @A1

Issue No.	Date	Description	Chkd
A	17/07/2019	Preliminary Issue for Coordination	KC
B	28/08/2019	Issue for DA	KC

LEGEND

- SITE BOUNDARY
- RL 00.00 PROPOSED GROUND LEVEL
- EX 00.00 EXISTING GROUND LEVEL
- LOW HEIGHT SCREEN FENCE

- 2.4m PALLISADE FENCE
- STORE LOCATION
- SEATING

- COLOURED CONCRETE
- PLAYGROUND MULCH
- PLAYGROUND SOFTFALL

- NATURAL TURF
- SYNTHETIC TURF
- SAND

- DECIDUOUS TREE
- EVERGREEN TREE
- SHRUBS, GROUND COVERS & GRASSES

Drawing Title
LANDSCAPE ARRANGEMENT PLAN 02

Project
NEW HOPE CAMPUS

Location
9 QUARRY ROAD, DURAL NSW 2158

Client
PACIFIC HILLS CHRISTIAN SCHOOL

Landscape Architect
NBRSLANDSCAPE ARCHITECTURE

Level 3, 4 Glen Street, Milsoms Point. NSW 2061 Australia
T: 61 2 9922 2344 F: 61 2 9922 1308
E: architects@nbrsarchitecture.com W: nbrsarchitecture.com

Any form of replication of this drawing in full or in part without the written permission of NBRSLANDSCAPE ARCHITECTURE Pty Ltd constitutes an infringement of the copyright.
ABN 16 002 247 565 © 2019

Date 28/08/2019
Scale 1:200 @ A1 | 1:400 @A3

Project No. 17369
Sheet No. LDA101

Revision No. B



PLANTING PALETTE

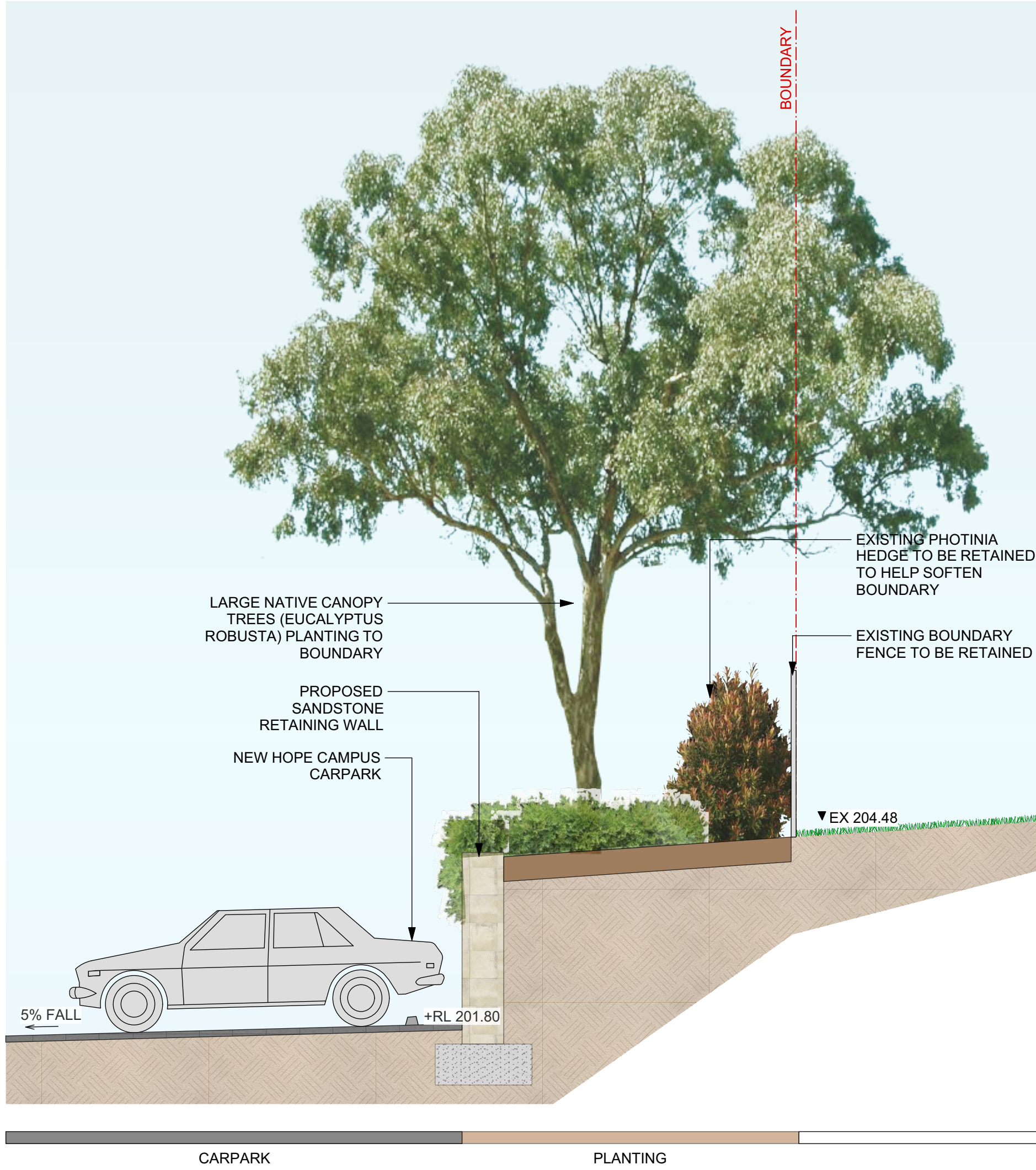
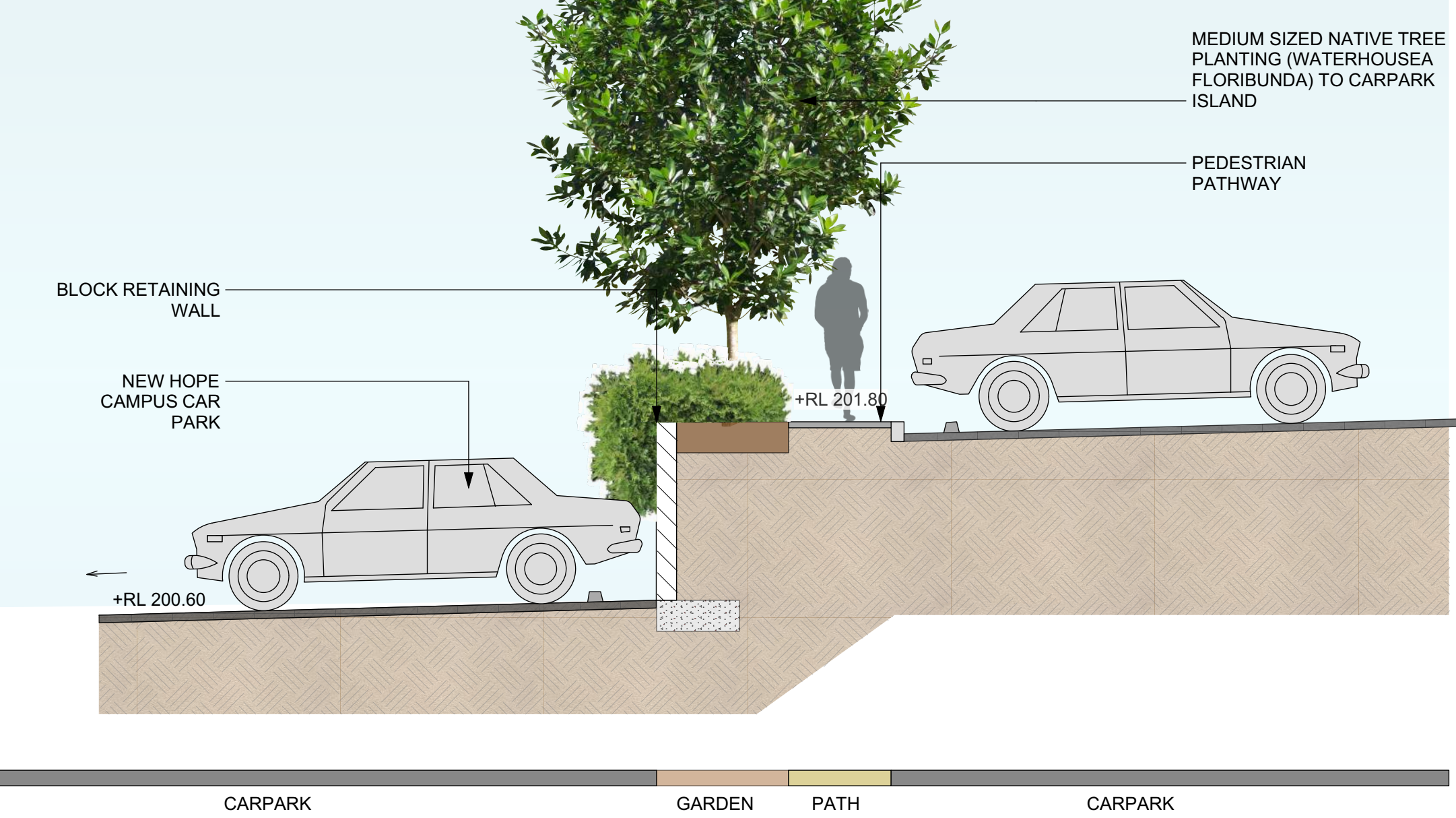
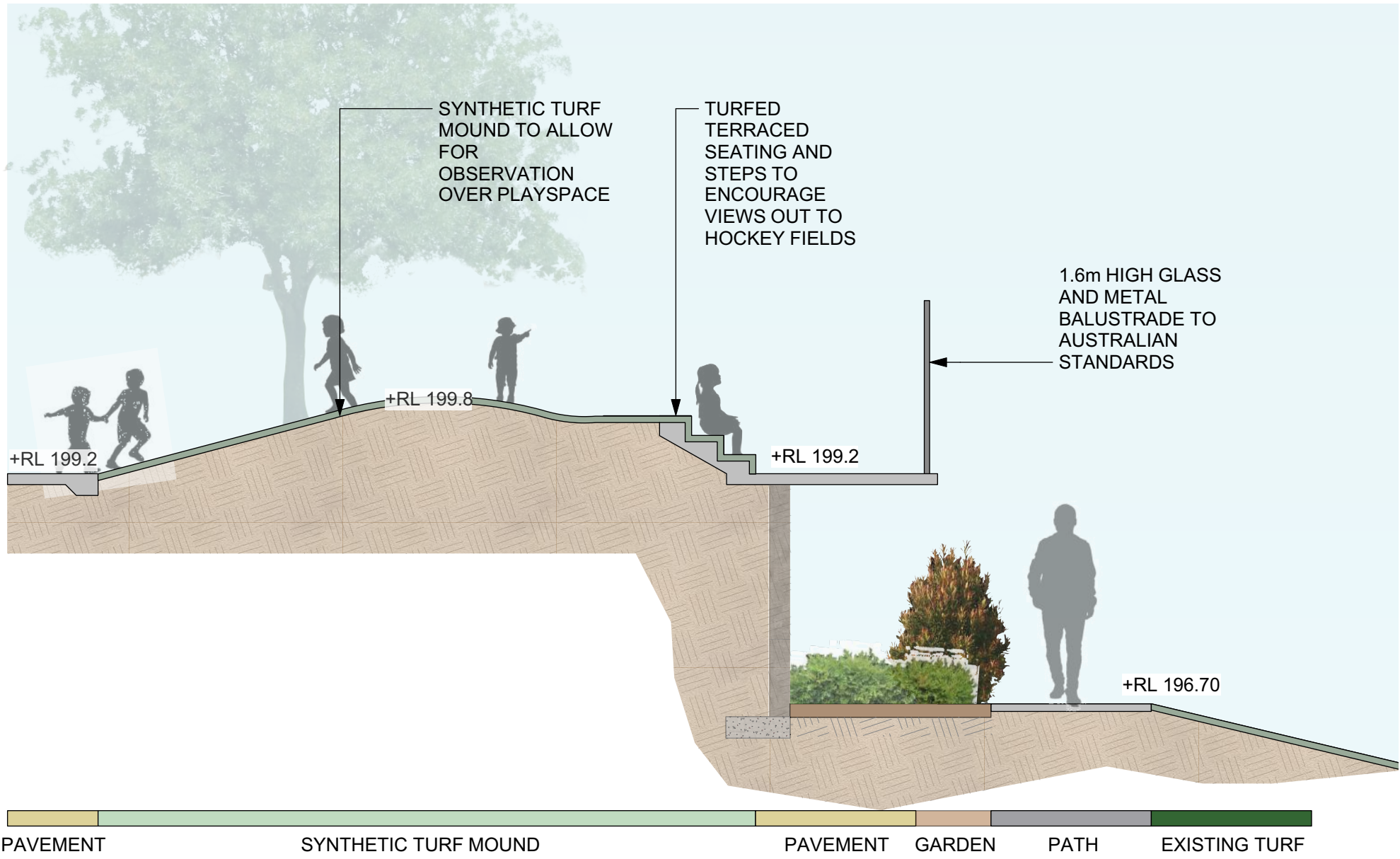

PRECEDENT IMAGES



SCREEN PLANTING TO BUILDING FACADES



DECORATIVE SCREENS TO BREAKOUTS



FIXED PLAY ELEMENTS



RELOCATION OF EXISTING PLAY EQUIPMENT FROM CURRENT SCHOOL



SYNTHETIC TURF MOUND



MIXED PLANTING WITHIN THE LANDSCAPE



MULTI-SURFACE SPACES



Issue No.	Date	Description	Chkd
A	17/07/2019	Preliminary Issue for Coordination	KC
B	28/08/2019	Issue for DA	KC

Drawing Title
LANDSCAPE SECTIONS

Project
NEW HOPE CAMPUS

Location
9 QUARRY ROAD, DURAL NSW 2158

Client
PACIFIC HILLS CHRISTIAN SCHOOL

Landscape Architect
NBRSLANDSCAPE
Level 3, 4 Glen Street, Milsons Point. NSW 2061 Australia
T: 61 2 9922 2344 F: 61 2 9922 1308
E: architects@nbrsarchitecture.com W: nbrsarchitecture.com
Any form of replication of this drawing in full or in part without the written permission of NBRSLANDSCAPE Pty Ltd constitutes an infringement of the copyright.
ABN 16 002 247 565 © 2019

Date 28/08/2019
Scale As Shown @ A1

Project No. 17369
Sheet No. LDA200
Revision No. B



PLANTING PALETTE

TREES



CUPANIOPSIS ANACARDIODIES
TUCKEROO



ELAEOCARPUS RETICULATUS
BLUEBERRY ASH



EUCALYPTUS ROBUSTA
SWAMP MAGONGANY



LAGERSTROEMIA INDICA
DYNAMITE CREPE MYRTLE



MAGNOLIA GRANDIFLORA 'LITTLE GEM'
LITTLE GEM MAGNOLIA



PRUNUS X BLIREANA
BLIREANA PLUM



PYRUS USSIRIENSIS
MANCHURIAN PEAR



QUERCUS ILEX
EVERGREEN OAK



SYZYGIIUM LUEHMANNII
SMALL LEAFED LILLY PILLY



WATERHOUSIA FLORIBUNDA
WEeping LILLY PILLY

SHRUBS



ACMENA SMITHII
LILLY PILLY



ANGIOZANTHUS FLAVIDA
KANGAROO PAW



ASPENIUM NIDUS
BIRDS NEST FERN



DORYANTHES EXCELSA
GYMEA LILLY



GARDENIA JASMINOIDES
GARDENIA



HEBE 'BLUE GEM'
HEBE



JUNIPERUS CONFERTA
SHORE JUNIPER



RHAPHIOLEPIS INDICA
INDIAN HAWTHORN



TULBAGHIA VIOLACEA
SOCIETY GARLIC



WESTRINGIA FRUTICOSA
COAST ROSEMARY

GROUNDCOVERS & CLIMBERS



ADJUGA REPTANS
BUGLEHERB



GAZANIA SP.
GAZANIA



HARDENBERGIA VIOLACEA
PRUPLE CORAL PEA



PENNISETUM ALOPECUROIDES
SWAMP FOXTAIL



DIANELLA REVOLUTA
BLUE FLAY LILLY



RED
NANDINA DOMESTICA
SACRED BAMBOO



YELLOW
ALPINIA ZERUMBET "VARIEGATA"
NATIVE GINGER



GREEN
PHILODENDRON XANADU
XANADU



PURPLE
ALTERNANTHERA DENATA
LITTLE RUBY



BLUE
PHLEBODIUM AUREUM
BLUE STAR FERN

GRASSES

CLASSROOM THEME PLANTING

Issue No.	Date	Description	Chkd
A	17/07/2019	Preliminary Issue for Coordination	KC
B	28/08/2019	Issue for DA	KC

Drawing Title
PLANTING PALETTE

Project
NEW HOPE CAMPUS

Location
9 QUARRY ROAD, DURAL NSW 2158

Client
PACIFIC HILLS CHRISTIAN SCHOOL

Landscape Architect
NBRSLARCHITECTURE.
LANDSCAPE

Level 3, 4 Glen Street, Milsons Point. NSW 2061 Australia
T: 61 2 9922 2344 F: 61 2 9922 1308
E: architects@nbrsarchitecture.com W: nbrsarchitecture.com

Any form of replication of this drawing in full or in part without the written permission of NBRSL & PARTNERS Pty Ltd constitutes an infringement of the copyright.
ABN 16 002 247 565 © 2019

Date 28/08/2019
Scale N/A

Project No. 17369
Sheet No. LDA200
Revision No. B

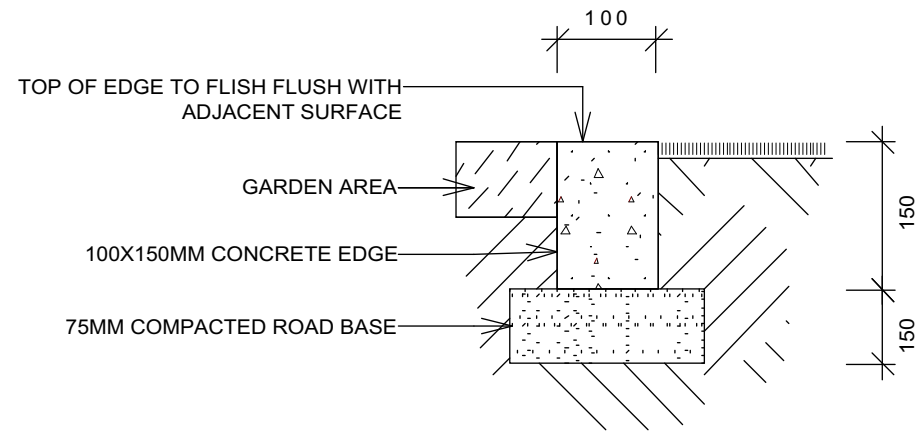

1 CONCRETE EDGE DETAIL
Scale: 1:10@A1

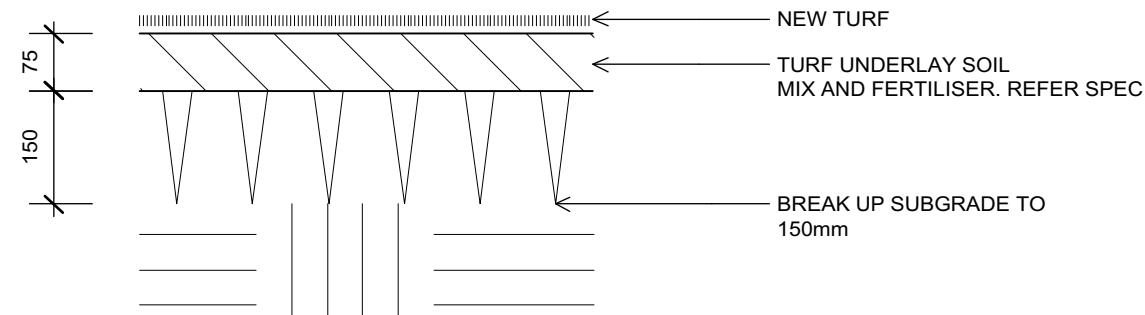

2 TYPICAL TURF DETAIL
Scale: 1:10@A1

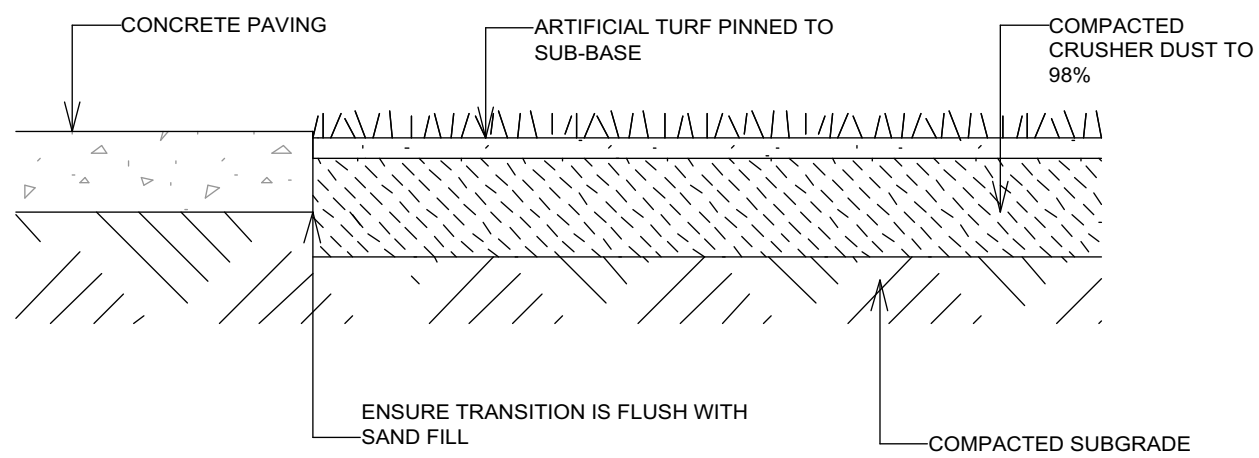

4 SYNTHETIC TURF DETAIL
Scale: 1:10@A1

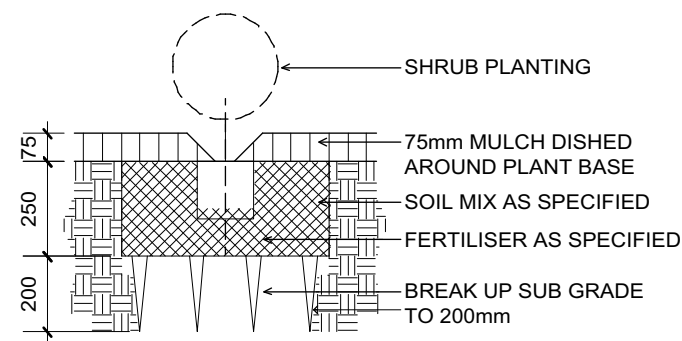

5 150M CONTAINER
Scale: 1:20@A1

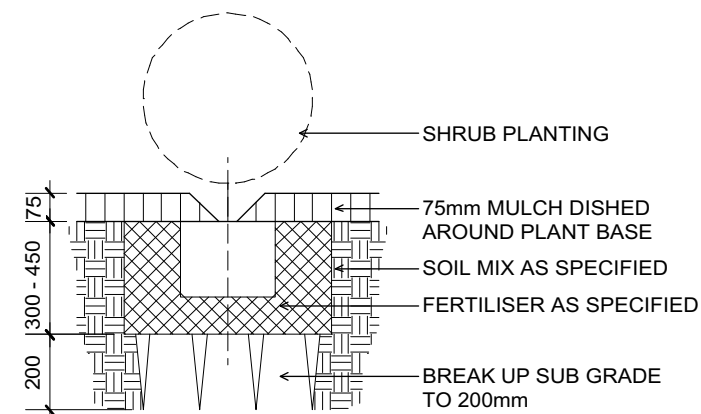

6 5 LITRE CONTAINER
Scale: 1:20@A1

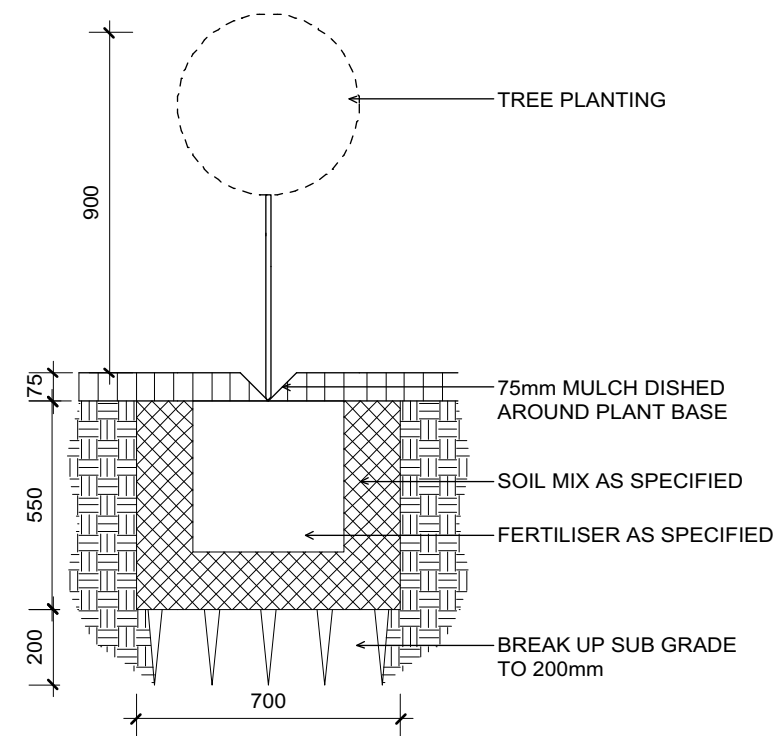

3 45 LITRE CONTAINER
Scale: 1:20@A1

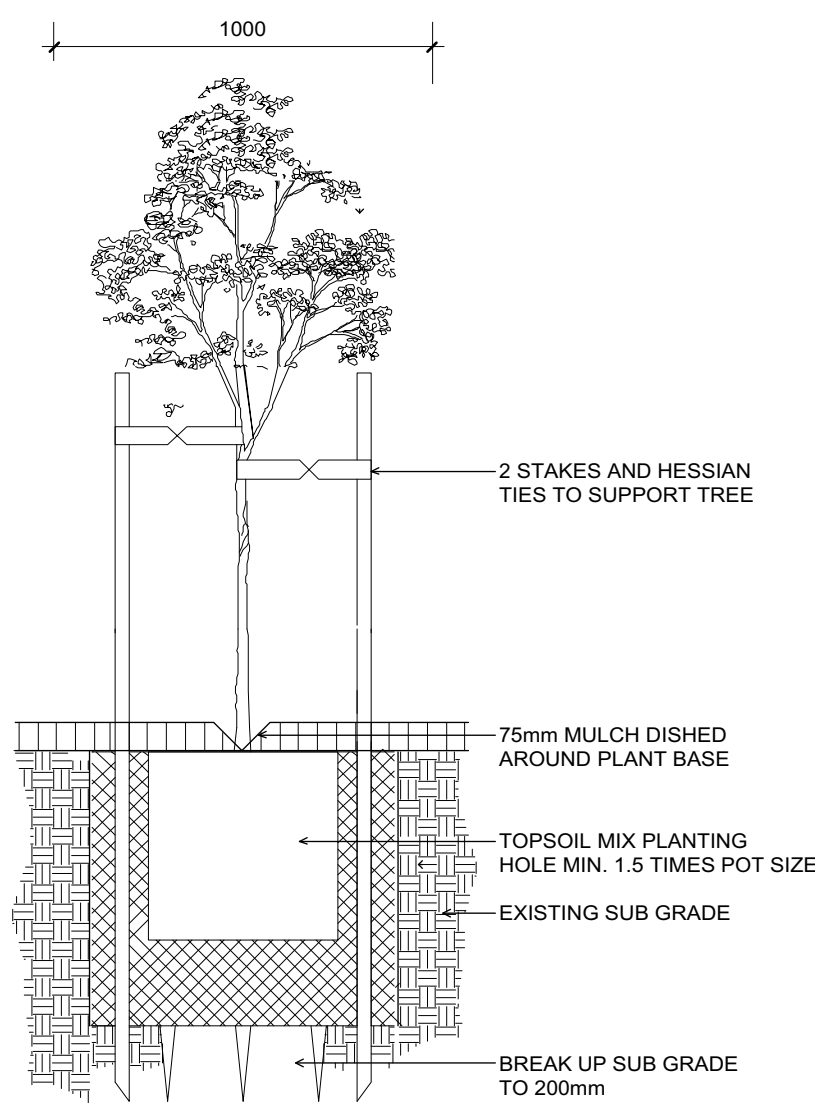

7 100-200 TYPICAL TREE PLANTING DETAIL
Scale: 1:20@A1

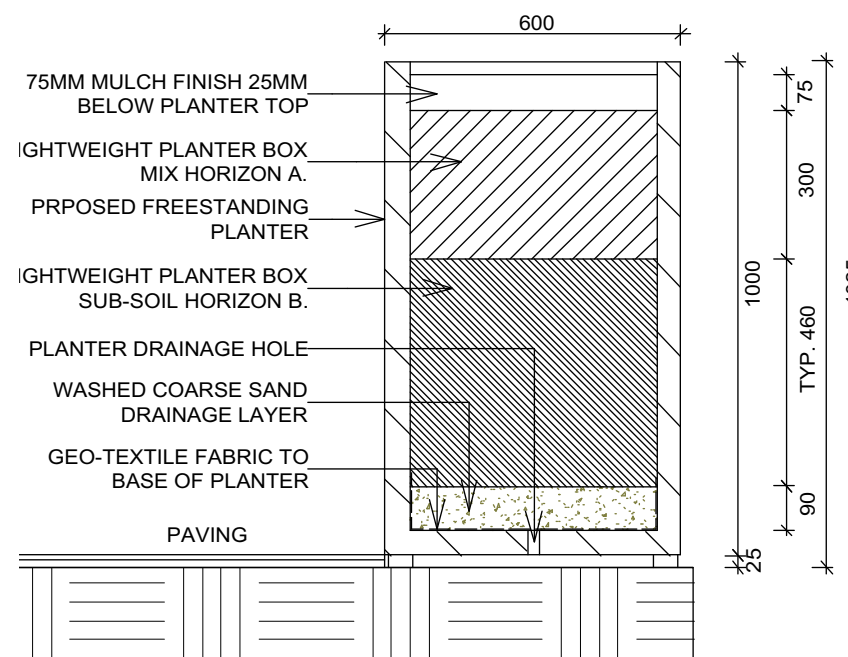

10 VEGETATION PLANTER DETAIL
Scale: 1:10@A1

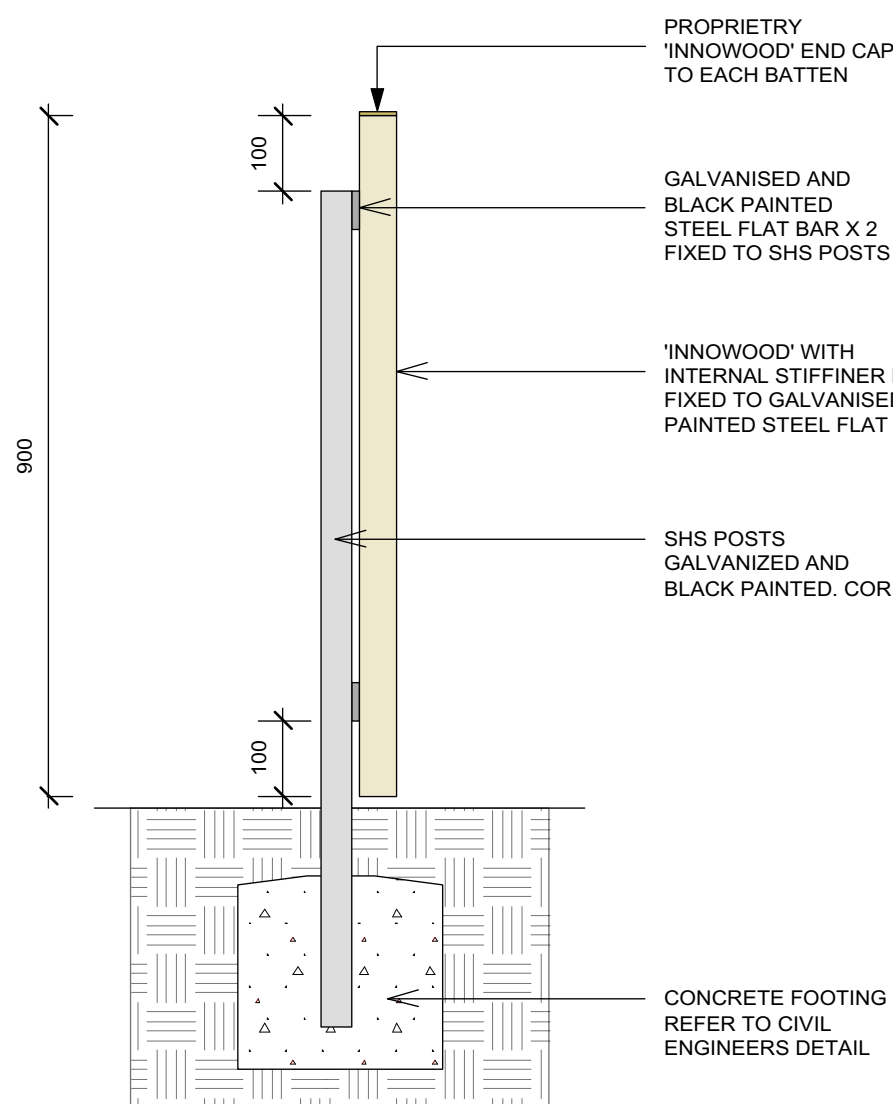

8 DECORATIVE FENCE 'DF' DETAIL (SECTION)
Scale: 1:10@A1

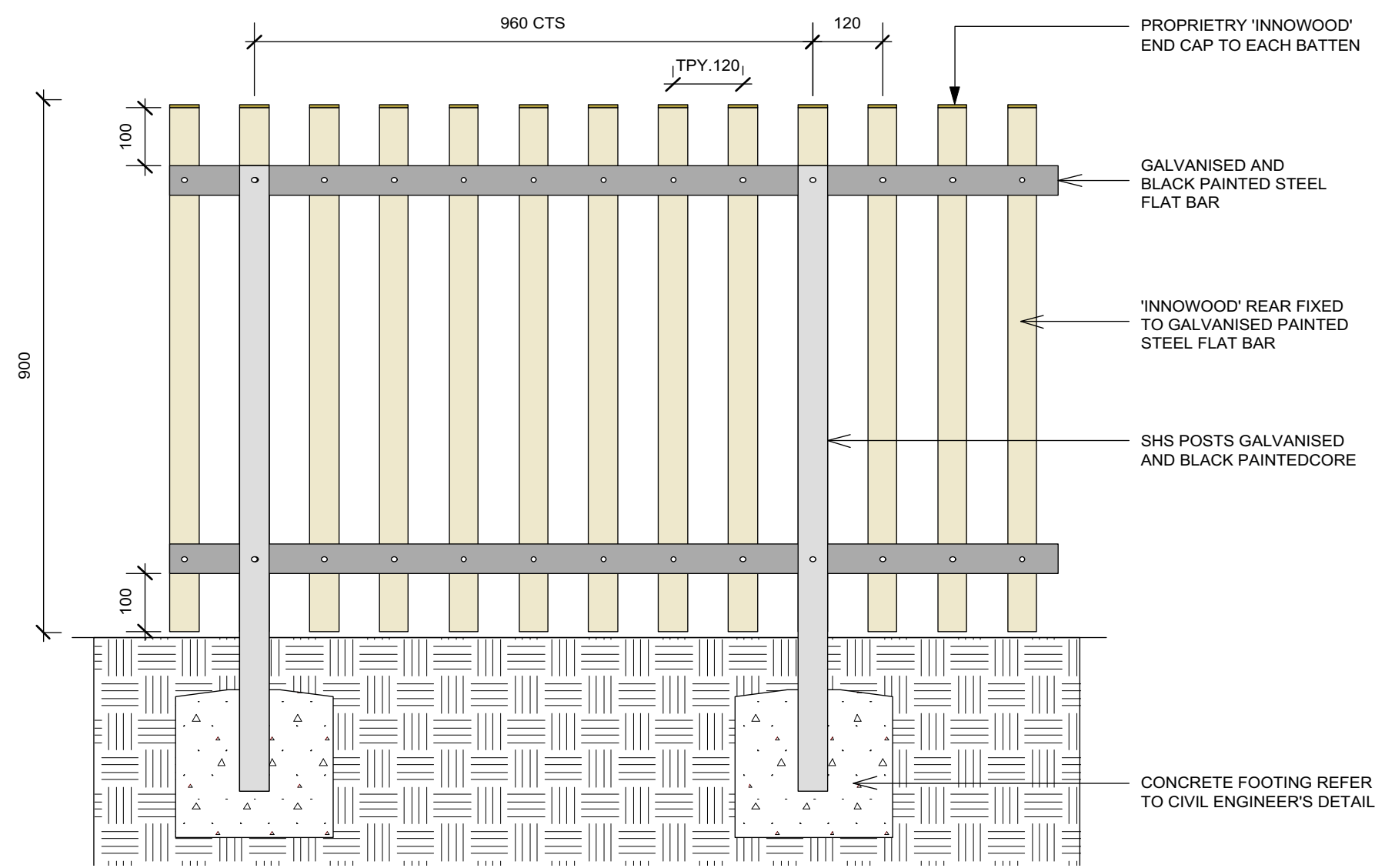

9 DECORATIVE FENCE 'DF' DETAIL (ELEVATION)
Scale: 1:10@A1

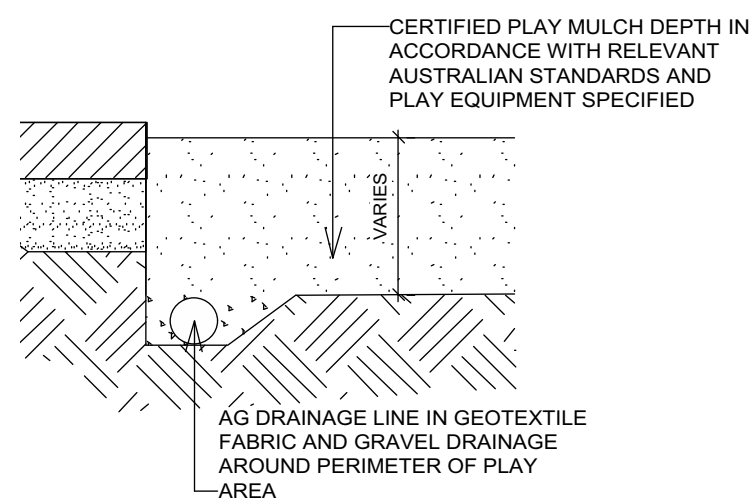

11 PLAYGROUND MULCH DETAIL
Scale: 1:20@A1

Issue No.	Date	Description	Chkd
A	17/07/2019	Preliminary Issue for Coordination	KC
B	28/08/2019	Issue for DA	KC

Drawing Title
LANDSCAPE DETAILS/ SPEC

Project
NEW HOPE CAMPUS

Location
9 QUARRY ROAD, DURAL NSW 2158

Client
PACIFIC HILLS CHRISTIAN SCHOOL

Landscape Architect
NBRSLARCHITECTURE
LANDSCAPE

Level 3, 4 Glen Street, Milsons Point. NSW 2061 Australia
T: 61 2 9922 2344 F: 61 2 9922 1308
E: architects@nbrsarchitecture.com W: nbrsarchitecture.com

Any form of replication of this drawing in full or in part without the written permission of NBRSL & PARTNERS Pty Ltd constitutes an infringement of the copyright.
ABN 16 002 247 565 © 2019

Date 28/08/2019
Scale N/A
0 5 M

Project No. 17369
Sheet No. LDA300
Revision No. B